

Y=21745.6 X=24198.0

Y=21737.6 X=24198.6

Y=21745.0 X=24187.0

Y=21737.0 X=24190.6

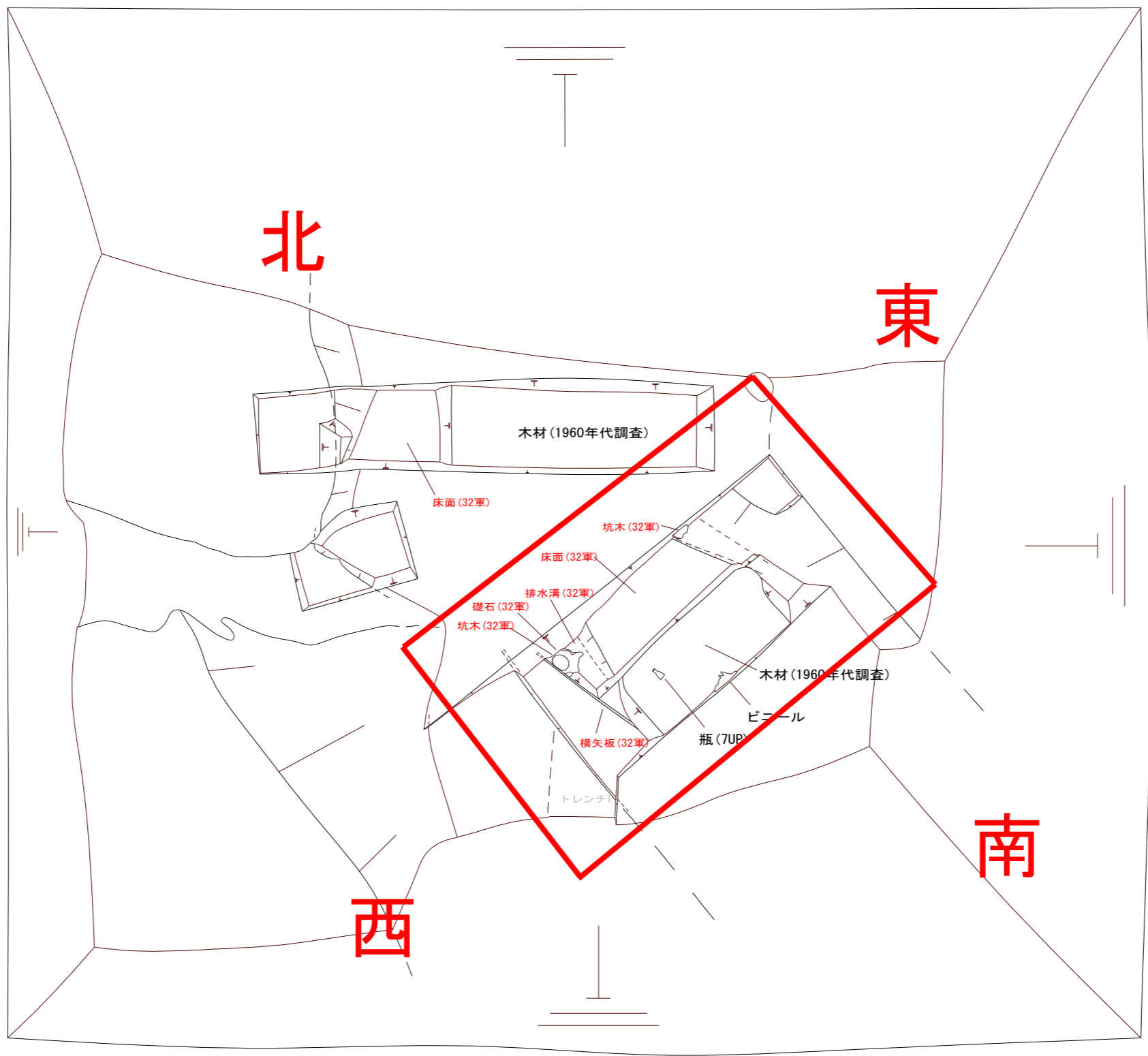

== : 破線は推定



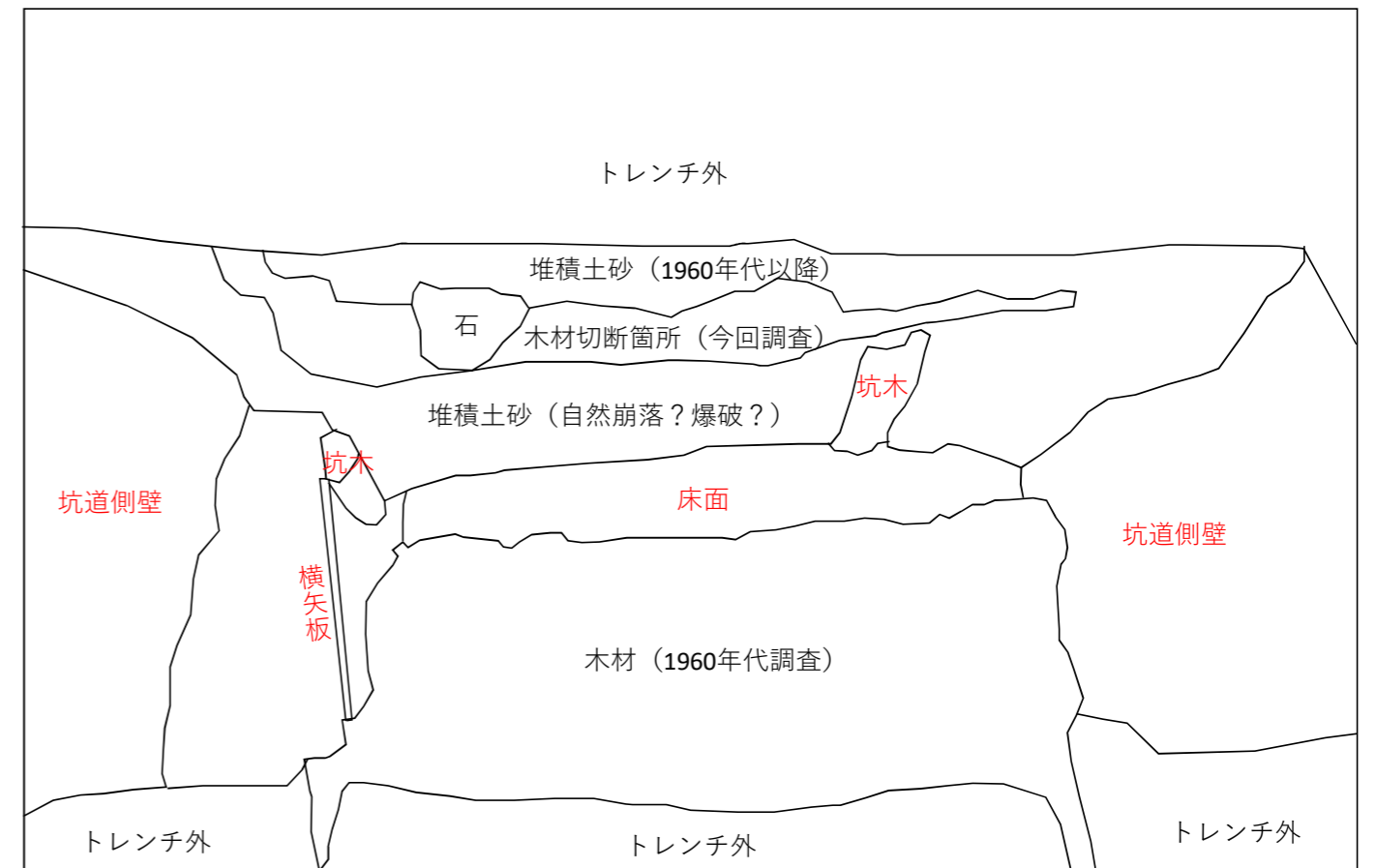
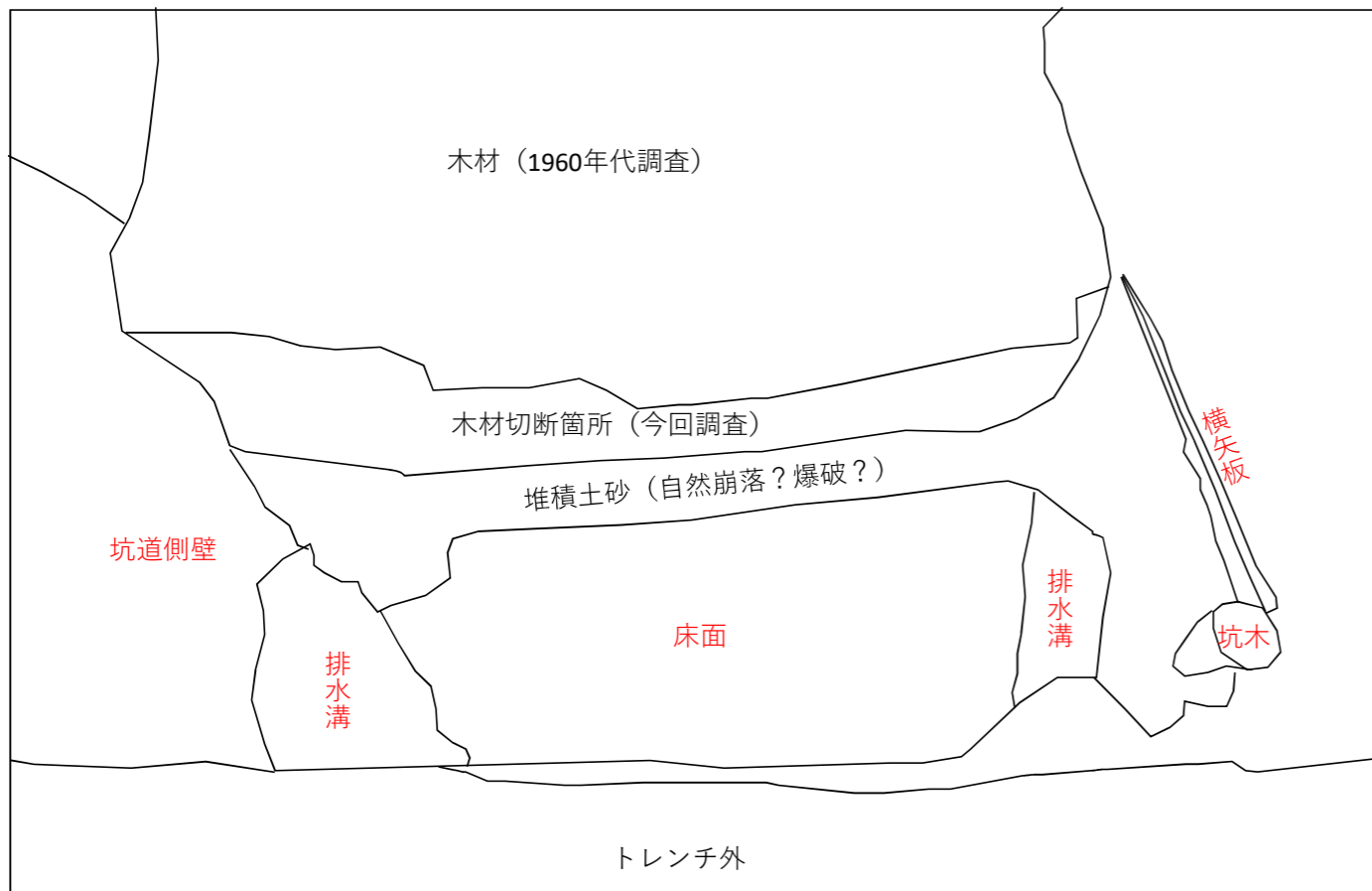

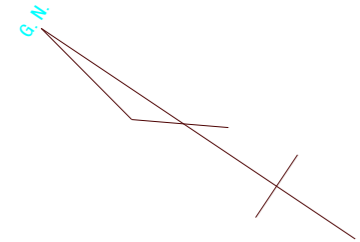

Y=21745.6 X=24198.0

Y=21737.6 X=24198.6

X=24187.0 Y=21745.0

X=24180.6 Y=21737.0

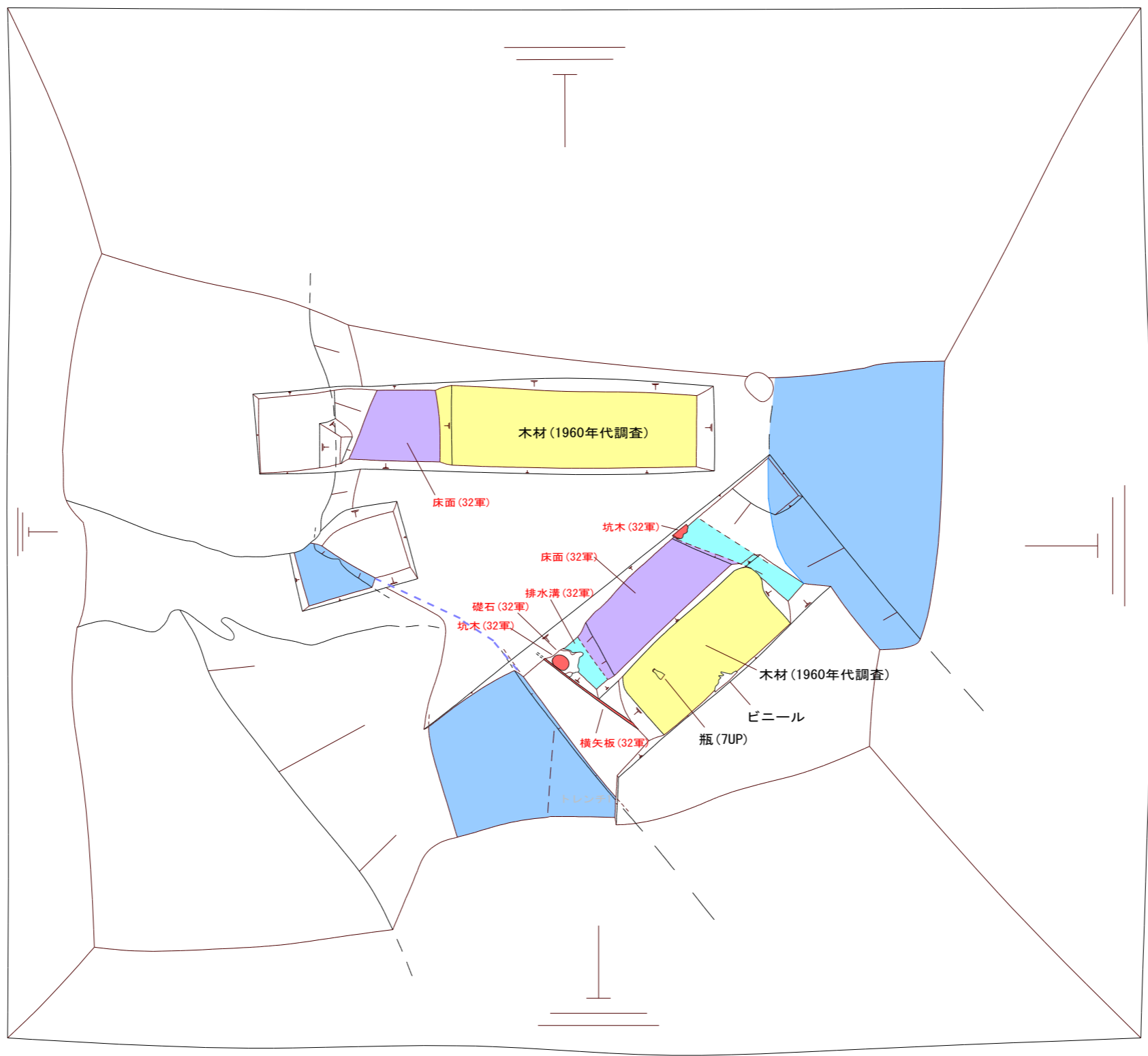

== : 破線は推定



# 掘削断面イメージ図

※地山とは改変されていない地盤のこと

※第32軍司令部関連の遺構は赤字で示す

木材(床板)  
(1960年代那覇市設置?)

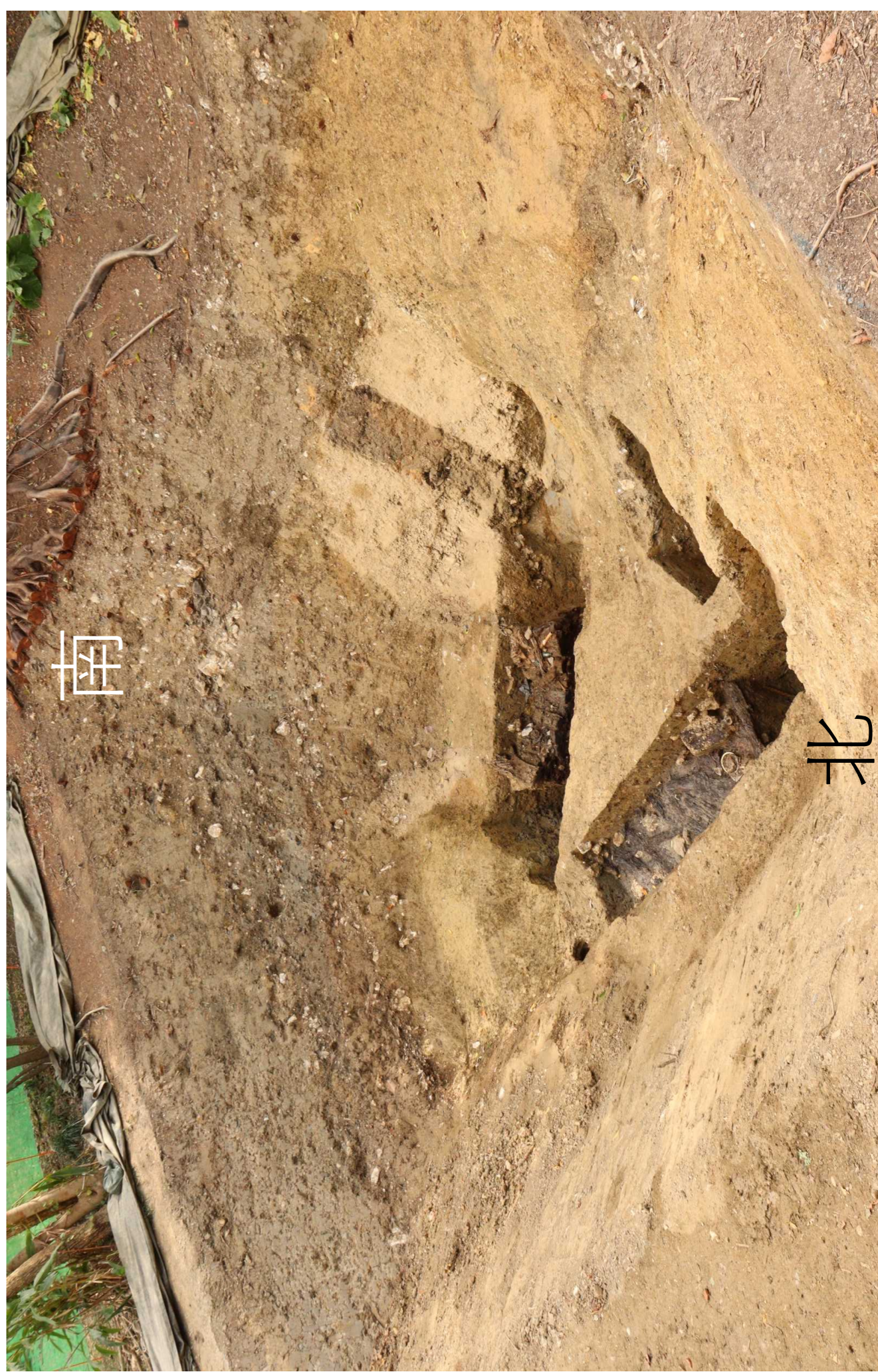
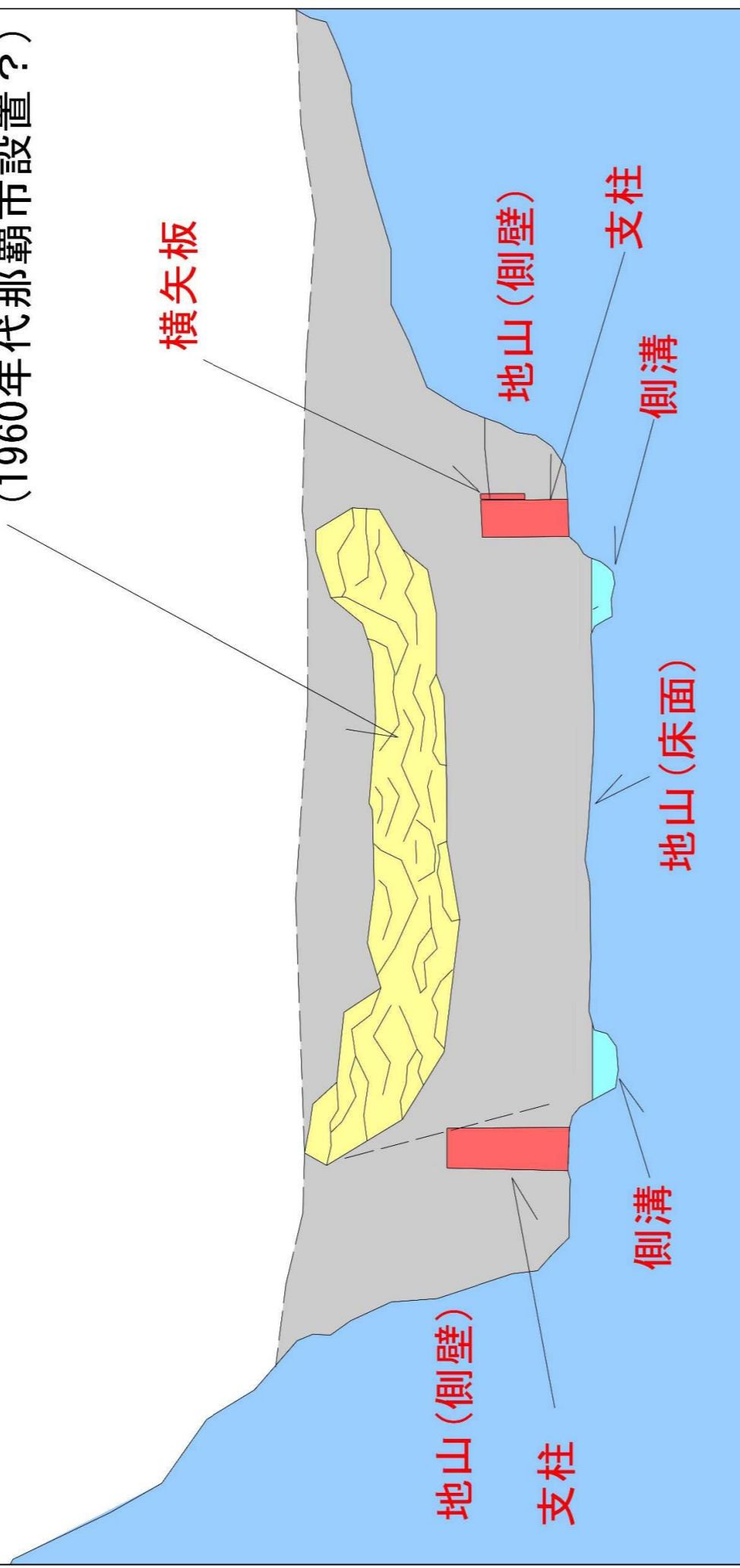





第5坑道(調査済)

現在の第5坑口

